

State of S^c Carolina

(288)

Pursuant to a warrant from John Thomas Esq. Com^r Locations dated the 21st day of Sept^r 1784. I have admeasured and laid out unto Young Griffen a Tract of land situated in Ninety six District East of the Ancient Boundary, on the South fork of the upper fork of Tyger River & Branches of Middle Tyger River Bounding on all sides on Vacant Land, & hath such shape and marks as the annexed plat represents.

Survey^d this 9th day of Nov^r Wm. Benson
Recorded the 23rd Dec^r 1784

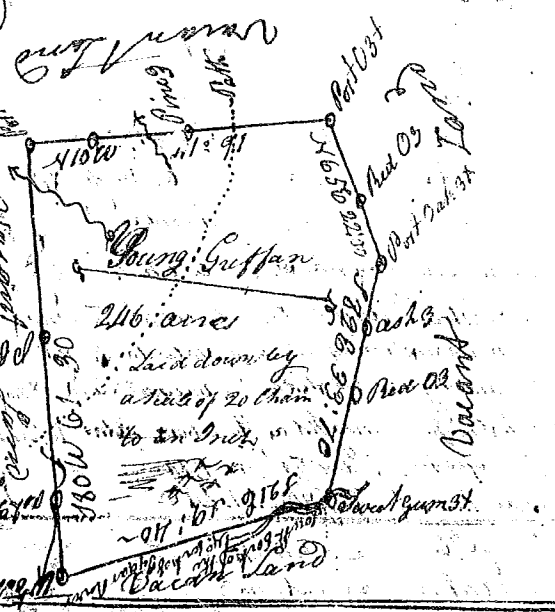

State of S^c Carolina

Pursuant to a warrant from John Thomas Esq. Com^r Locations dated the 21st of Sept^r 1784. I have admeasured and laid out unto John Clayton a Tract of one Hundred acres of land situated in Ninety six District West of the Ancient Boundary, on Morgan's fork of Middle Tyger River Bounding on all sides on Vacant Land and hath such shape and marks as the annexed plat represents.

Survey^d this 22nd Sept^r 1784. Wm. Benson

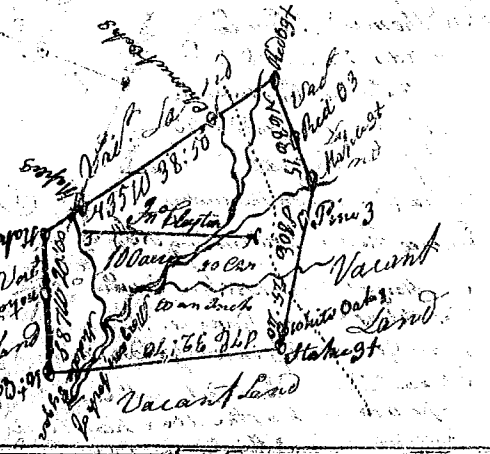

State of S^c Carolina 96 District

the East side of the Ancient Boundary Pursuant to a warrant from John Thomas Esq. Com^r Locations for the 4th Secⁿ of Saluda River, dated the 8th July 1784. I have admeasured & laid out unto Arthur Crocker a Tract of land containing 290 acres lying on both sides of Richland Creek Bounded to the N^e by an old Survey line all other sides on Vacant Land & hath such shape and marks as the annexed plat represents.

Survey^d the 10th July 1784. Wm. Benson
Recorded the 31st Dec^r 1784



State of S^c Carolina Ninety six District on the East side of the Ancient Boundary.

Pursuant to a warrant from John Thomas Esq. Com^r for 96 District, dated the 10th July 1784. I have admeasured & laid out unto Arthur Crocker a Tract of land containing 100 acres lying on both sides of Richland Creek Bounded to the S^w by Vacant Land all other sides Vacant Land, and hath shape and marks as the annexed plat represents.

Survey^d the 10th July 1784. By
Recorded the 1st January 1785

